

REFERENCE SEASTROM WORKMANSHIP STD. 8.4.1.W2

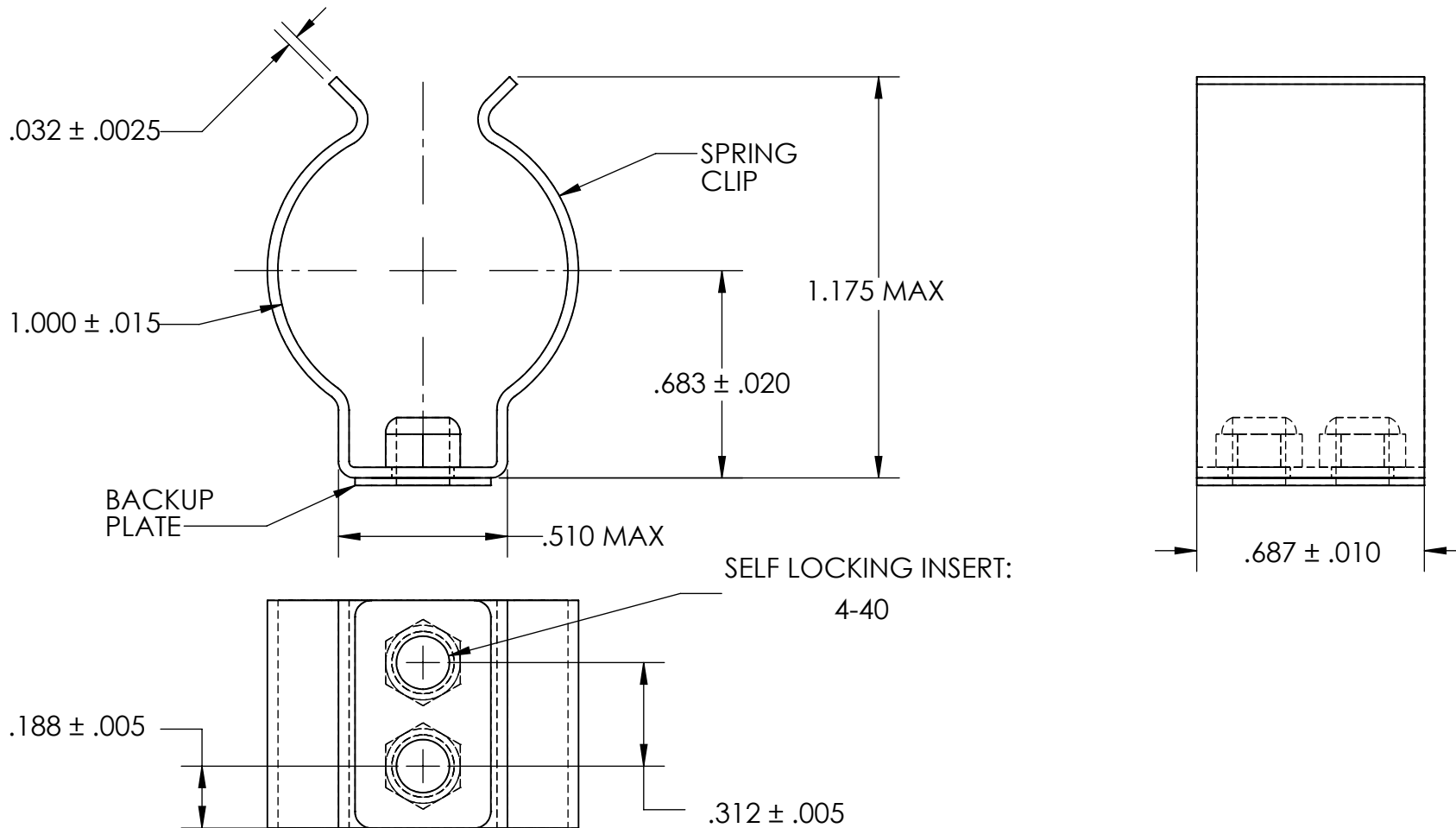

SELF LOCKING INSERT:
4-40

NOTES

1. BERYLLIUM COPPER, ANNEALED
2. HEAT TREAT: 73-79 HR15N (SPRING CLIP ONLY)
3. CADMIUM PLATE PER AMS QQ-P-416 TYPE II CLASS 2 (SPRING CLIP AND BACKUP PLATE)
4. DIMENSIONS ARE TAKEN WITH THE PART CLAMPED TO A FLAT SURFACE AND A DUMMY COMPONENT IN PLACE.
5. DIMENSIONS APPLY PRIOR TO PLATING.

PROPRIETARY AND CONFIDENTIAL
THE INFORMATION CONTAINED IN THIS DRAWING IS THE SOLE PROPERTY OF SEASTROM MANUFACTURING. ANY REPRODUCTION IN PART OR AS A WHOLE WITHOUT THE WRITTEN PERMISSION OF SEASTROM MANUFACTURING IS PROHIBITED.

| | | | |
|--|-----------|------|---|
| DIMENSIONS ARE IN INCHES TOLERANCES: FRACTIONAL $\pm 1/32$ ANGULAR: MACH $\pm 1/2 \text{ Deg}$ TWO PLACE DECIMAL $\pm .01$ THREE PLACE DECIMAL $\pm .005$ | NAME | DATE | SEASTROM MFG SPRING CLIP |
| | DRAWN | | |
| | CHECKED | | |
| | ENG APPR. | | |
| | MFG APPR. | | |
| MATERIAL | COMMENTS: | | SIZE |
| SEE NOTE 1 | | | A |
| HEAT TREAT | | | DWG. NO. |
| SEE NOTE 2 | | | 4543-100-68-1-C2 |
| FINISH | | | REV. |
| SEE NOTE 3 | | | - |
| DRAWING IS NOT TO SCALE | | | SHEET 1 OF 1 |