

REFERENCE SEASTROM WORKMANSHIP STD. 8.4.1.W2

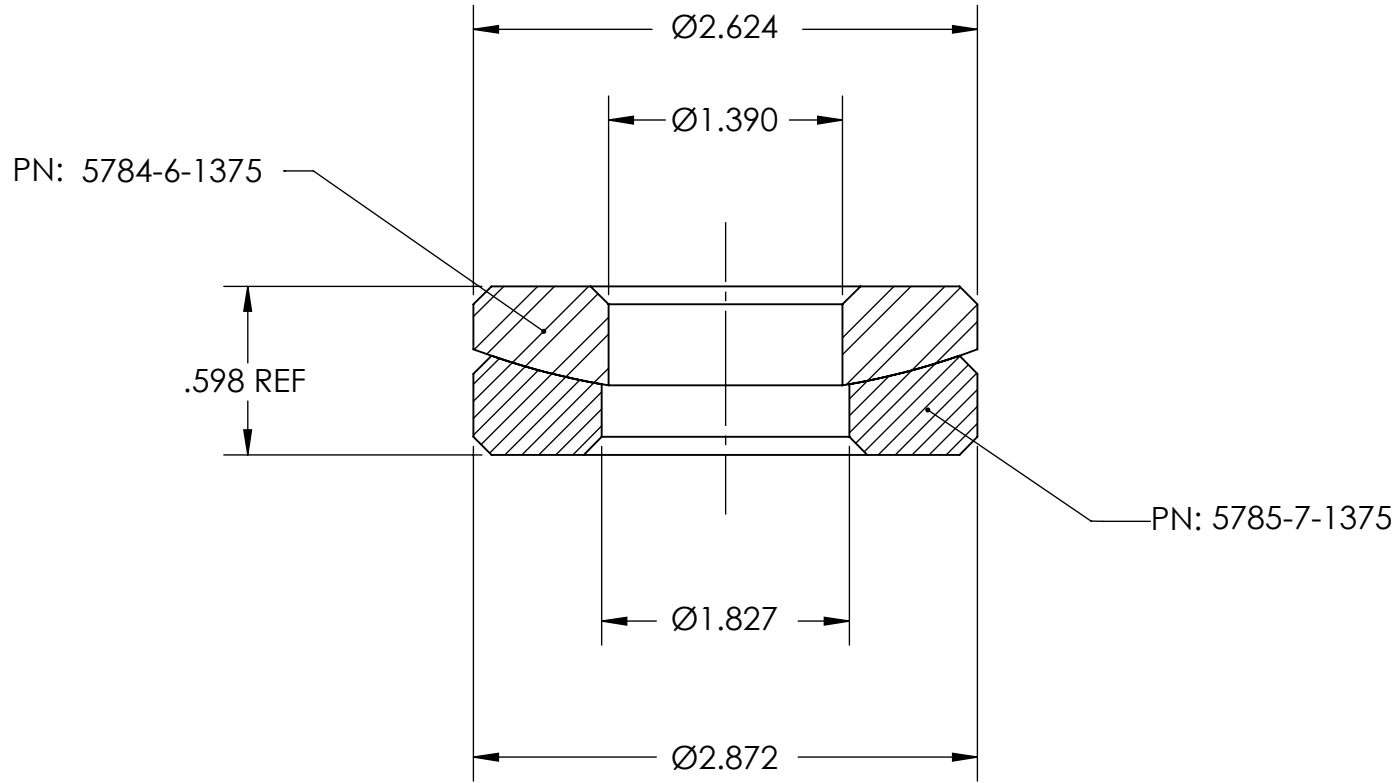

NOTES

1. SCREW SIZE: 1-3/8
2. PARTS SHOULD BE FREE FROM BURRS AND VISUAL DEFECTS.

PROPRIETARY AND CONFIDENTIAL
 THE INFORMATION CONTAINED IN THIS DRAWING IS THE SOLE PROPERTY OF SEASTROM MANUFACTURING. ANY REPRODUCTION IN PART OR AS A WHOLE WITHOUT THE WRITTEN PERMISSION OF SEASTROM MANUFACTURING IS PROHIBITED.

DIMENSIONS ARE IN INCHES TOLERANCES: FRACTIONAL ± 1/32 ANGULAR: MACH ± 1/2 Deg TWO PLACE DECIMAL ± .01 THREE PLACE DECIMAL ± .005		NAME	DATE	SEASTROM MFG
MATERIAL COLD ROLLED STEEL	HEAT TREAT SEE INDIVIDUAL PRINTS	DRAWN	CHECKED	
FINISH NONE		ENG APPR.	MFG APPR.	
		Q.A.	COMMENTS:	
		DRAWING IS NOT TO SCALE		SIZE A DWG. NO. 5786-67-1375 REV. -
				SHEET 1 OF 1