

STYLE 1

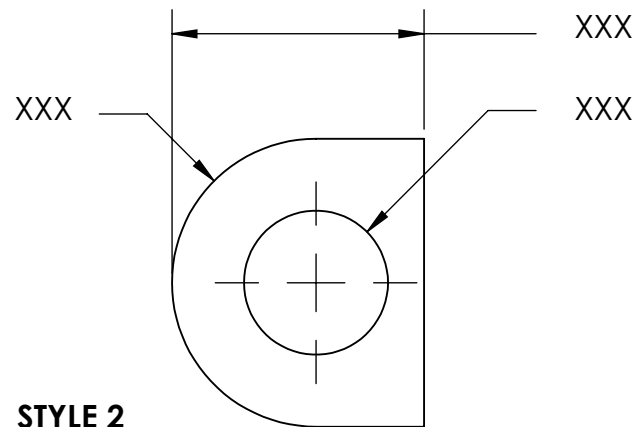

STYLE 2

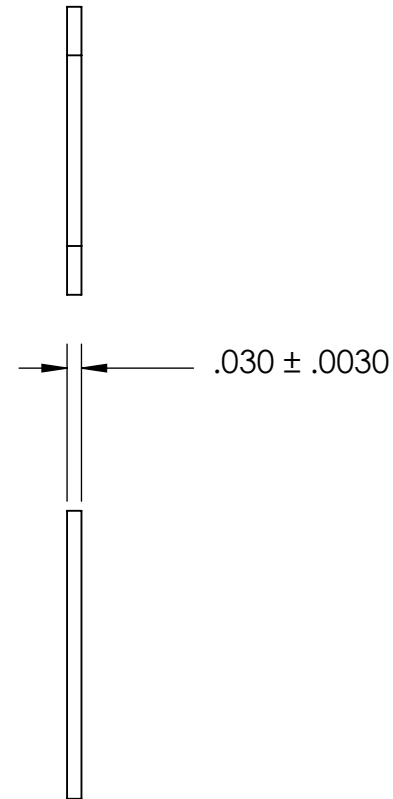

NOTES:

1. CADMIUM PLATE PER AMS QQ-P-416 TYPE II CLASS 2
2. STYLE 1
3. DIMENSIONS APPLY PRIOR TO PLATING.

PROPRIETARY AND CONFIDENTIAL

THE INFORMATION CONTAINED IN THIS DRAWING IS THE SOLE PROPERTY OF SEASTROM MANUFACTURING. ANY REPRODUCTION IN PART OR AS A WHOLE WITHOUT THE WRITTEN PERMISSION OF SEASTROM MANUFACTURING IS PROHIBITED.

DIMENSIONS ARE IN INCHES
TOLERANCES:
FRACTIONAL $\pm 1/32$
ANGULAR: MACH $\pm 1/2$ Deg
TWO PLACE DECIMAL $\pm .01$
THREE PLACE DECIMAL $\pm .005$

MATERIAL
COLD ROLLED STEEL

FINISH
SEE NOTE 1

DRAWING IS NOT TO SCALE

	NAME	DATE
DRAWN		
CHECKED		
ENG APPR.		
MFG APPR.		
Q.A.		
COMMENTS:		

SEASTROM MFG

CLIPPED WASHER

SIZE	DWG. NO.	REV.
A	5734-7-C2	-