

SCREW SIZE CLEARANCE HOLE: 4 (TYP)
SLOTTED BUS BAR - SEE INSET

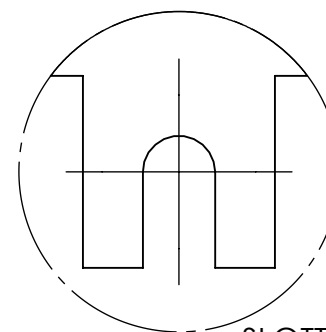

SLOTTED BUS BARS ONLY

NOTES

1. TIN PLATE PER ASTM B545 CLASS B

2. No. TERMINALS: 16

3. CIRC MIL AREA: 2,526

4. DIMENSIONS APPLY PRIOR TO PLATING.

PROPRIETARY AND CONFIDENTIAL

THE INFORMATION CONTAINED IN THIS DRAWING IS THE SOLE PROPERTY OF SEASTROM MANUFACTURING. ANY REPRODUCTION IN PART OR AS A WHOLE WITHOUT THE WRITTEN PERMISSION OF SEASTROM MANUFACTURING IS PROHIBITED.

DIMENSIONS ARE IN INCHES
 TOLERANCES:
 FRACTIONAL: $\pm 1/32$
 ANGULAR: MACH $\pm 1/2$ Deg
 TWO PLACE DECIMAL $\pm .01$
 THREE PLACE DECIMAL $\pm .005$

MATERIAL
 COPPER

FINISH
 SEE NOTE 1

DRAWING IS NOT TO SCALE

	NAME	DATE
DRAWN		
CHECKED		
ENG APPR.		
MFG APPR.		
Q.A.		
COMMENTS:		

SEASTROM MFG

BUS BAR

SIZE **A** DWG. NO. 5010-1-16S

REV.
 -

SHEET 1 OF 1