

1.906

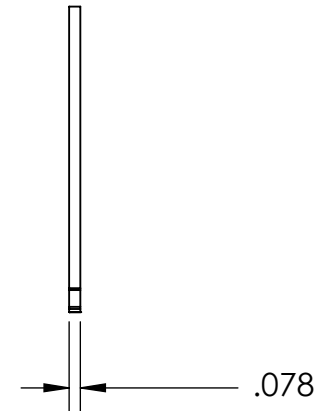
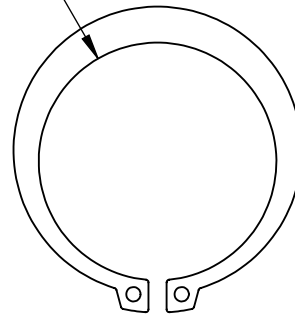

SIZING

SHAFT DIA.: Ø2.062

GROOVE DIA.: Ø1.946

GROOVE WIDTH: Ø.086

NOTES

1. PHOSPHATE COATING

2. STYLE: EXTERNAL

3. DIMENSIONS APPLY PRIOR TO PLATING.

PROPRIETARY AND CONFIDENTIAL

THE INFORMATION CONTAINED IN THIS DRAWING IS THE SOLE PROPERTY OF SEASTROM MANUFACTURING. ANY REPRODUCTION IN PART OR AS A WHOLE WITHOUT THE WRITTEN PERMISSION OF SEASTROM MANUFACTURING IS PROHIBITED.

DIMENSIONS ARE IN INCHES
TOLERANCES:
FRACTIONAL $\pm 1/32$
ANGULAR: MACH $\pm 1/2$ Deg
TWO PLACE DECIMAL $\pm .01$
THREE PLACE DECIMAL $\pm .005$

MATERIAL
SPRING STEEL

FINISH
SEE NOTE 1

DRAWING IS NOT TO SCALE

	NAME	DATE
DRAWN		
CHECKED		
ENG APPR.		
MFG APPR.		
Q.A.		
COMMENTS:		

SEASTROM MFG

RETAINING RING

SIZE	DWG. NO.	REV.
A	2727-33-206	-

SHEET 1 OF 1